



Product Description

VST-PC Series:

1. Body Size: 3/8", 1/2", 3/4" 1"
2. Valve: Poppet Type
3. Body materials: Zinc-plated carbon steel body.
4. Seals materials: Standard Nitrile (Buna-N)
5. Working temperature: -20° C + 100° C. Others on request
6. Back-up Ring: Teflon
7. Threads available: BSPP female threads.

Interchange Standard Tema T, Cejn 525, Stucchi IRC.

Features

1. Poppet valves are mated in stainless steel perch that maintains valve alignment and prevents flow checking.
2. Both the coupling sleeve and the nipple's body are hardened to make the VST-TC series couplings resistant to damage from brinelling and mechanical shock.
3. The durable-ball-locking mechanism ensures a reliable connection every time.
4. Connections under residual pressure is allowed in the male or in the female (PC VERSION)

Applications

Versatile VST-TC series couplings are used in a wide range of hydraulic applications including construction equipment, manufacturing machinery, and in-plant systems. They can be found anywhere the fluid transfer lines need to be connected and disconnected for operation or electronics and automotive industry.

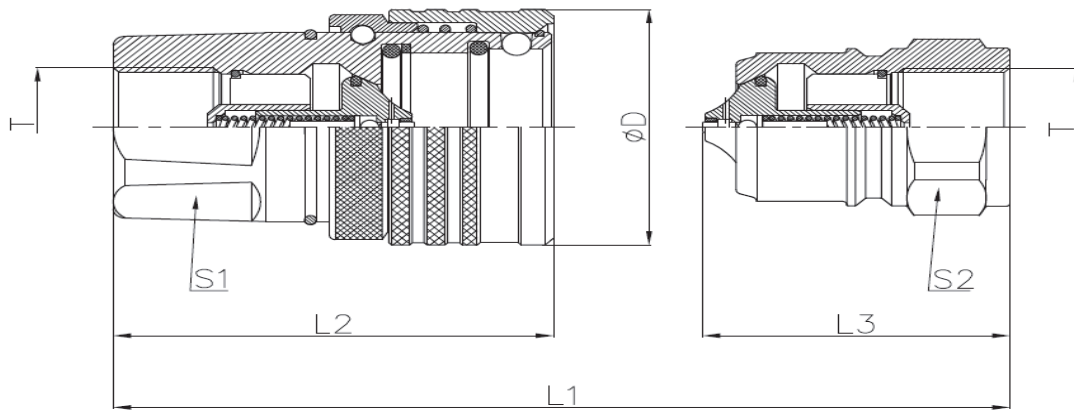

Type	ISO Ø	L1	L2	L3	ØD	S1	S2	T
VST-TC38	10	77	60	42	34	24	22	BSPP 3/8
VST-TC12	12,5	82	65	46	40	30	27	BSPP 1/2
VST-TC34	20	92	72	52	52	38	36	BSPP 3/4
VST-TC100	25	113	88	60	62	45	46	BSPP 1"

Technical characteristics

Type	ISO Ø	Q.	Max. Operating Pressure			Burst Pressure		
			Coupled	Male	Female	Coupled	Male	Female
	mm	l/min	Bar	Bar	Bar	Bar	Bar	Bar
VST-TC38	10	46	460	370	370	1300	1100	1100
VST-TC12	12,5	90	400	330	330	1100	1000	1000
VST-TC34	20	212	330	330	330	1000	1000	1000
VST-TC100	25	378	330	330	330	1000	1000	1000