



## Product Description

VHP Series:

1. Body Size: 1/4", 3/8"
2. Valve: Ball valve
3. Body materials: Zinc-plated carbon steel body.
4. Seals materials: Standard Nitrile (Buna-N)
5. Working temperature: -20° C + 100° C. Others on request
6. Back-up Ring: Teflon

Interchange Standard Parker 3000 series, Faster PVVM, Stucchi IVHP.

## Features

1. Ball valves are mated with a solid metal perch that maintains valve alignment and prevents flow checking.
2. The screw system allows connection and disconnection under pressure.

## Applications

VHP couplings with their threaded locking system and precision ball-type check valves are designed for extremely high pressure applications.

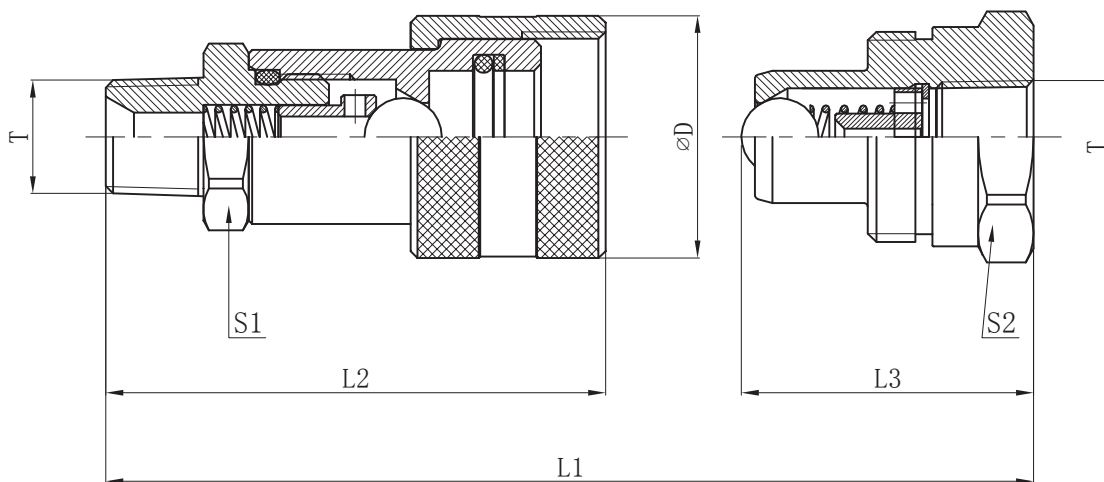

Type	ISO Ø	L1	L2	L3	ØD	S1	S2	T
VHP14	6,3	81	52	39	28	21	19	NPT 1/4
VHP38	10	96	61	41	35	24	32	NPT 3/8

### Technical characteristics

Type	ISO Ø	Q.	Operant ing Pressure	Burst Pressure			Fluid spillage
				Coupled	Male	Female	
	mm	l/min	Bar	Bar	Bar	Bar	cc
VHP14	6,3	5	700	2270	1530	2050	0,2
VHP38	10	9	700	2220	1540	2020	0,6