



Product Description

VSA-PC Series: ISO 7241-1A Interchange

1. Body Size: 1/2"
2. Valve: Poppet Type with pressure valve
3. Body materials: Zinc-plated carbon steel body
4. Seals materials: Standard Nitrile (Buna-N)
5. Working temperature: -20° C + 100° C. Others on request
6. Back-up Ring: Teflon
7. Threads available: BSPP female threads.

Interchange Standard Parker 6600 series, Faster ANV, Aeroquip FD 56, Snap Tite 61, Dnp PBV1, Stucchi BIR.

Features

1. Poppet valves are mated with a solid metal perch that maintains valve alignment and prevents flow checking.
2. Both the coupler' sleeve and the nipple's body are hardened to make the VSA series couplings resistant
3. The durable-ball-locking mechanism ensures a reliable connection every time.
4. VSA-PC series couplings interchange with couplings meeting ISO 7241-1, Series A.
5. Connection under residual pressure i allowed in the male or in the female (PC version). The residual pressure released by the small holes during connection.

Applications

Versatile VSA-PC series couplings are used in a wide range of hydraulic applications including construction equipment, manufacturing machinery, and in-plant systems. They can be found anywhere the fluid transfer lines need to be connected and disconnected for operation or maintenance of equipment.

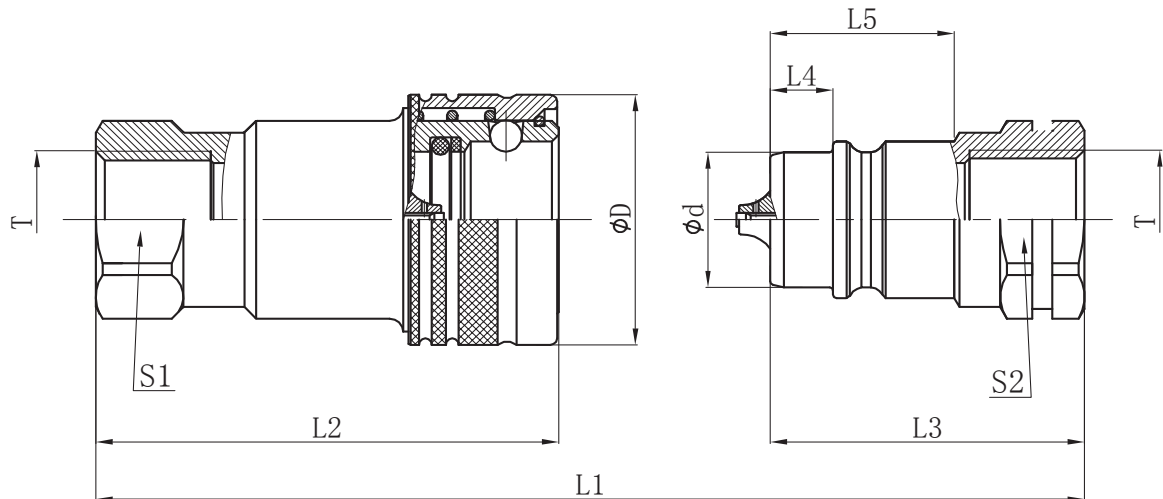

Type	ISO Ø	L1	L2	L3	ØD	S1	S2	T
VSA-PC12	12,5	93,5	68,5	51,4	38	27	27	BSPP 1/2

Technical characteristics

Type	ISO Ø	Q.	Max. Q	Max. Operating Pressure			Burst Pressure		
				Coupled	Male	Female	Coupled	Male	Female
	mm	l/min	l/min	Bar	Bar	Bar	Bar	Bar	Bar
VSA-PC12	12,5	45	90	250	250	250	1250	1000	1460