

TECHNICAL DATA

Standard:	ISO 14541
Sleeve:	double acting
Occlusion:	poppet
Locking:	screw
Material:	steel
Finishing:	Zinc plated
Threads:	BSPP
Standard seals:	NBR
Working temperature:	-25° C + 100° C
Optional seals:	FKM
Workings pressure:	300-450 bar
Connection under residual pressure:	both male or female side



Applications:

For their strength VSV couplers are highly recommended for heavy duty industrial applications.

The screw system allows the connection either with male or female under pressure.

Interchange Standard

Dnp PVX
Stucchi VD
Holmbury HS
Voswinkel HD
Faster CVV

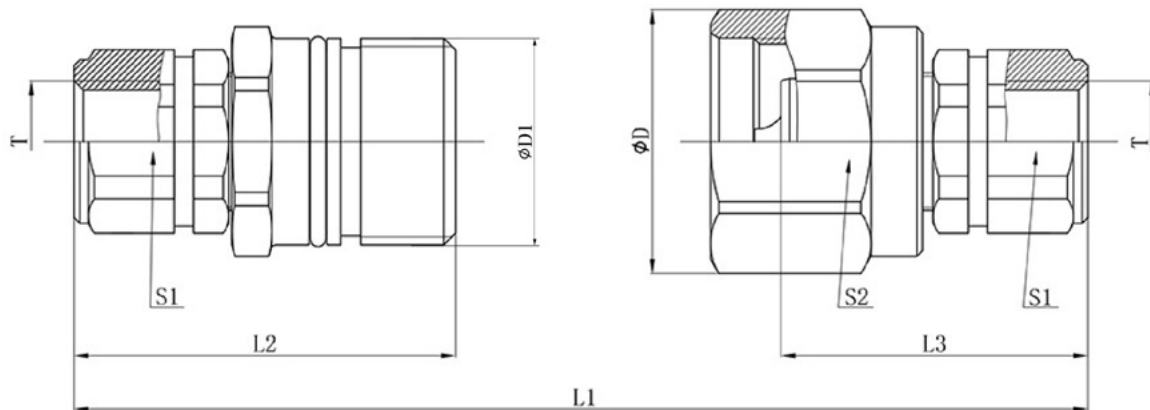

Type	ISO Ø	L1	L2	L3	ØD	ØD1	S1	S2	S3	T
VSV14	6,3	90,8	60	56,9	34,5	24x200	19	30	19	BSPP 1/4"
VSV38	10	98,6	64,2	61,5	34,3	28x200	24	30	24	BSPP 3/8"
VSV12	12,5	103,6	66,5	64,8	42	36x200	30	36	30	BSPP 1/2"
VSV34	20	132,1	85	78,9	48	42x200	36	41	36	BSPP 3/4"
VSV100	25	151	100	86	55	48x300	50	50	50	BSPP 1"
VSV114	31,5	186	113	132	80	70x300	55	75	55	BSPP1"1/4"

TECHNICAL CHARACTERISTICS

Type	ISO Ø	Q.	Max. Q	Max. Operating Pressure			Burst Pressure	Fluid spillage
				Coupled	Male	Female		
				Bar	Bar	Bar		
VSV14	6,3	12	20	350	1400	1400	1400	0,8
VSV38	10	23	46	325	1830	1300	1530	1,4
VSV12	12,5	45	90	300	1490	1220	1510	2,7
VSV34	20	106	148	250	1490	1070	1390	9,3
VSV100	25	189	200	250	1100	1110	1110	16
VSV114	31,5	288	380	200	700	700	700	30

ACCESSORIES



ISO Ø	Female Dust Plug	Male Dust Cap	Colour	Material
6,3	VSV-04F	VSV-04M	Red	Plastic
10	VSV-06F	VSV-06M	Red	Plastic
12,5	VSV-08F	VSV-08M	Red	Plastic
20	VSV-12F	VSV-12M	Red	Plastic
25	VSV-16F	VSV-16M	Red	Plastic
31,5	VSV-20F	VSV-20M	Red	Plastic