



Product Description

VVA Series: French m

1. Body Size: 12,5
2. Valve: Flat face
3. Body materials: Steel
4. Seals materials: Standard Nitrile (Buna-N)
5. Working temperature: -20° C + 100° C. Others on request
6. Back-up Ring: Teflon
7. Threads available: BSPP and Metric.

Interchange Standard Dnp VVT, Faster VA.

Features

1. VAA couplings are commonly used in Agriculture Market for braking systems and consequently very similar to VF braking valves. Characterized by screw-to-connect sleeve, their interchangeability is based on market driven standards.

Applications

Versatile VVA series couplings are used in Agriculture Market

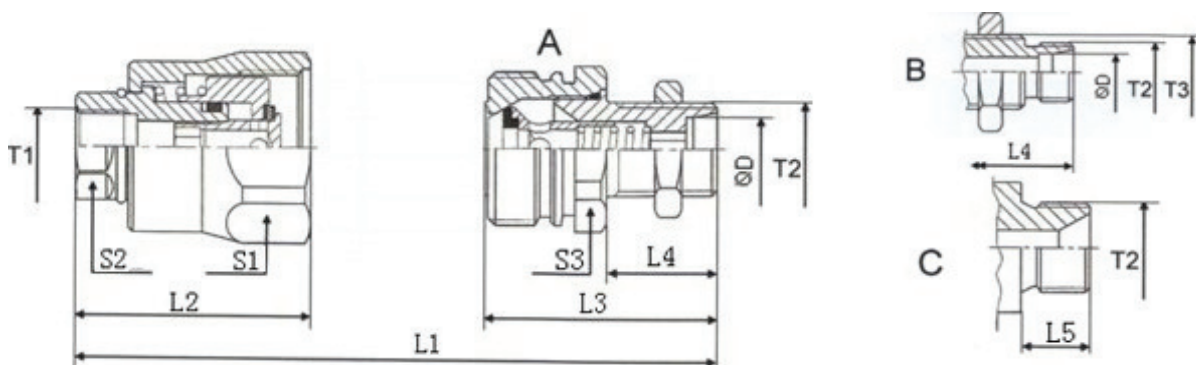

Type	ISO Ø	L1	L2	L3	L4	ØD	S1	S2	T1	T2
VVA38	12,5		52,8				41	22	BSPP 3/8	BSPP 3/8
VVA1815	12,5		52,8				41	22	M-18x150	M-18x150
VVA12	12,5	88,5		48	15					BSPP 1/2
VVA1815	12,5	88,5		49	21	12				M-18x150

Technical characteristics

Type	ISO Ø	Q.	Max. Operating Pressure			Burst Pressure		
			Coupled	Male	Female	Coupled	Male	Female
	mm	l/min	Bar	Bar	Bar	Bar	Bar	Bar
VVA38	12,5	24	200	200	200	1380	1030	600
VVA1815	12,5	24	200	200	200	1380	1030	600
VVA12	12,5	24	200	200	200	1380	1030	600
VVA1815	12,5	24	200	200	200	1380	1030	600